

SZ20 SYSTEM

For horizontal layout - invisible fixing system (cassettes) on top-hat profiles

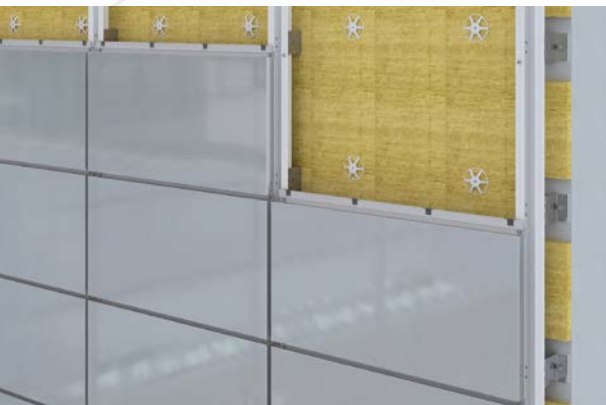

Principle

Rainscreen cladding using interlocking on horizontal top-hat profiles with invisible fixings.

Applications

Horizontal layout with straight-line forms.

Benefits

- Invisible fixings
- Quick installation using interlocking after adjusting the starter profile
- Oversize cassettes (up to 4 to 6 meters) available
- Reduces fixing operations by spacing out fixing main profile
- Main profile maintains the aesthetic appearance of the horizontal joint as well as allowing draining water

Installation

- Fix the main top-hat profiles
- Fix the starter profile
- Install the cassettes
- Lock at the cassette top

Our Offer

- Ready-to-use cassettes
- Framework profiles supplied

